

SPALDING®

Steel Front Mount Fan Backboard

Model # 413-208 & 413-209

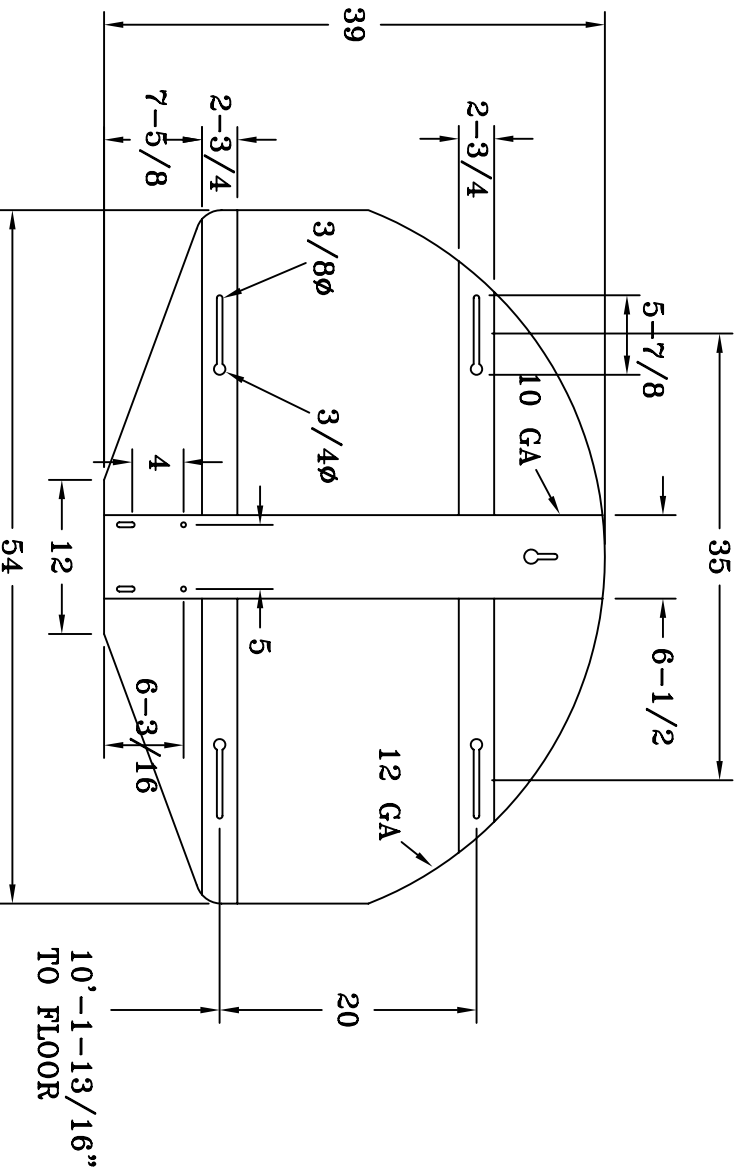

STEEL FAN BACKBOARD

DO NOT SCALE

PART# 0413208/0413209



SPALDING SPECIFICATIONS

DATE: 01/01/06

MODEL NUMBER: 413209 & 413208

DESCRIPTION: Steel Front Mount Fan Backboard

SPECIFICATIONS:

Backboard shall have a finished regulation size of 54" x 39".

Backboard shall be made of 12 gauge solid steel shell with a 1/2" flange. The board contains reinforced horizontal channels for vibration-free action and a vertical strong-back that strengthens the critical rim area.

The finish shall be electrostatically powder coated white with a graffiti resistant finish.

The board shall have a 35" x 20" mounting pattern and a goal mounting pattern of 5" x 5". Square target is optional and included on model #0413208.

The board shall have a 1-year warranty. Practice, game, intramural and recreational play are covered. Direct mount extends warranty to three years. Vandalism and acts of Nature are not covered.

SHIPPING WEIGHT: 80 lbs.